

9236 Broadview Road

2,825± SF Office Space Available For Lease

Broadview Heights, Ohio 44147 (Cuyahoga County)



9236 Broadview Road, Broadview Heights, Ohio

Property Features:

- 2,825± SF Total Space Available
- 1,692± SF Showroom/Shop Area
- 702± SF Garage Area with an OHD 9'x 9'
- One Office
- Storage Area
- Reception Area
- Two Restrooms
- Tenants Also Include:
 - ~Vanity Avenue Salon
 - ~OLA – Ohio Landscapers Association
 - ~Crystal Asian Spas
- Highly Visible Location on Northwest Corner of Broadview Road and Royalton Road (SR 82)
- Close Proximity to Interstate 77

**\$2,500.00 Monthly Plus Gas & Electric
Modified Gross**

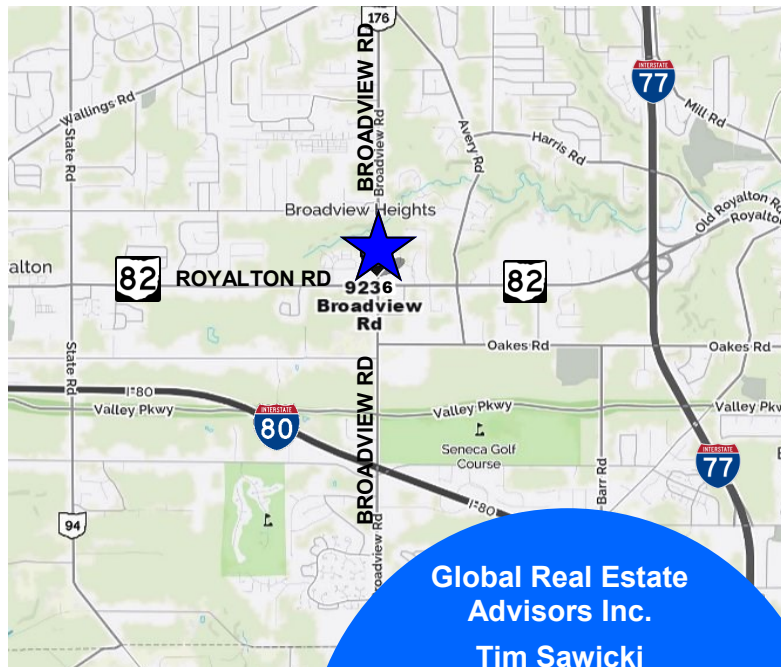

Global Real Estate
Advisors Inc.

Tim Sawicki

440-255-5552 x 222

440-283-5143 Cell

Tim@GlobalCommercialRE.com

Neil Sawicki, SIOR, Broker

440-255-5552 x 221

Neil@GlobalCommercialRE.com



GLOBAL

www.GlobalCommercialRE.com

8585 East Ave., Mentor, Ohio 44060

Real Estate Advisors Inc.
BROKER

This information has been secured from sources we believe are reliable, but we make no representations or warranties, expressed or implied, as to the accuracy of the information. References to condition, square footage or age are approximate. Buyer or Tenant acknowledges that they are relying on their own investigations and are not relying on Broker provided information. Procuring broker shall only be entitled to a commission, calculated in accordance with the rates approved by our principal only if such procuring broker executes a brokerage agreement acceptable to us and our principal and the conditions as set forth in the brokerage agreement are fully and unconditionally satisfied. Although all information furnished regarding property for sale, rental, or financing is from sources deemed reliable, such information has not been verified and no express representation is made nor is any to be implied as to the accuracy thereof and it is submitted subject to errors, omissions, change of price, rental or other conditions, prior sale, lease or financing, or withdrawal without notice and to any special conditions imposed by our principal.

9236 Broadview Road

2,825± SF Office Space Available For Lease

Broadview Heights, Ohio 44147 (Cuyahoga County)



FRONT VIEW FACING BROADVIEW RD



SIDE VIEW FROM ROYALTON ROAD

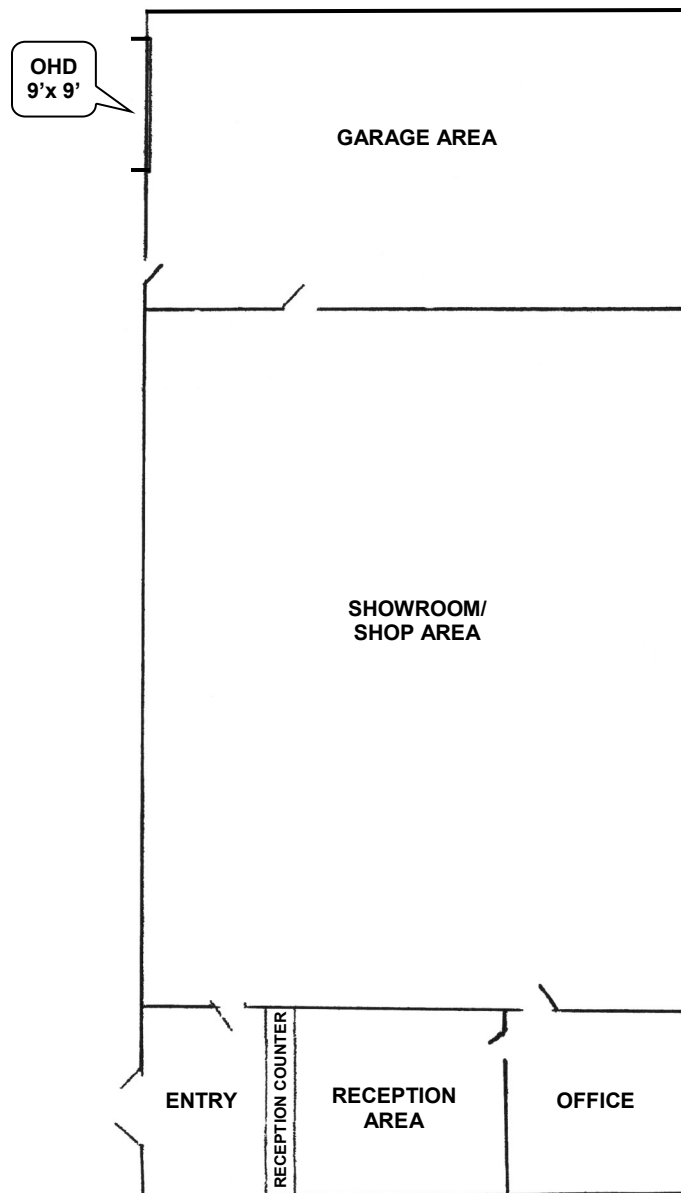
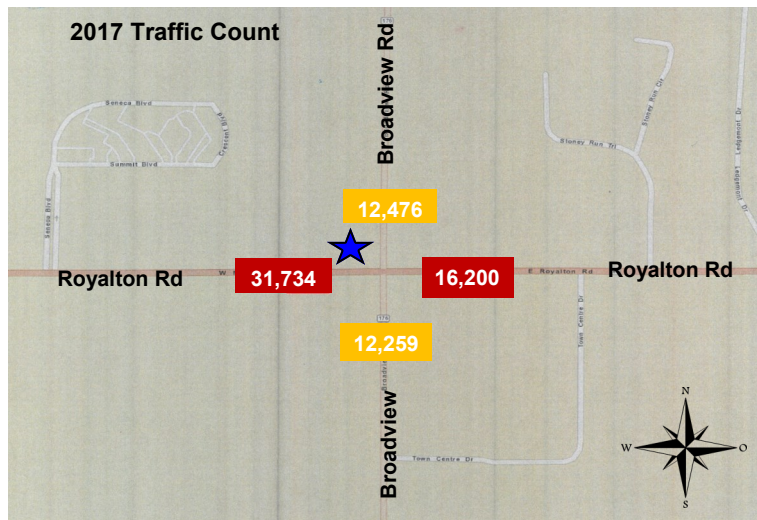

*Dimensions are Approximate



www.GlobalCommercialRE.com
8585 East Ave., Mentor, Ohio 44060

Real Estate Advisors Inc.
BROKER

**Global Real Estate
Advisors Inc.**

Tim Sawicki

440-255-5552 x 222

440-283-5143 Cell

Tim@GlobalCommercialRE.com

Neil Sawicki, SIOR, Broker

440-255-5552 x 221

Neil@GlobalCommercialRE.com

This information has been secured from sources we believe are reliable, but we make no representations or warranties, expressed or implied, as to the accuracy of the information. References to condition, square footage or age are approximate. Buyer or Tenant acknowledges that they are relying on their own investigations and are not relying on Broker provided information. Procuring broker shall only be entitled to a commission, calculated in accordance with the rates approved by our principal only if such procuring broker executes a brokerage agreement acceptable to us and our principal and the conditions as set forth in the brokerage agreement are fully and unconditionally satisfied. Although all information furnished regarding property for sale, rental, or financing is from sources deemed reliable, such information has not been verified and no express representation is made nor is any to be implied as to the accuracy thereof and it is submitted subject to errors, omissions, change of price, rental or other conditions, prior sale, lease or financing, or withdrawal without notice and to any special conditions imposed by our principal.